

Quick Change Hex Bit System

Anyone who has used a power drill is familiar with the frustrating and time-consuming task of using a chuck key to change drill bits and other tools. By installing a Quick Chuck in your drill, you can snap in any tool that has a 1/4" indented hex shank in seconds. Drill bits and smooth shank tools can be quickly converted to work with the system.

Code #	Description
801-6-9010	1/4" shaft, installs in any 1/4" or larger standard adjustable jaw chuck
801-6-9030	3/8" x 1-1/8" long shaft, for installation in keyless adjustable jaw chuck
801-6-9000	Fits 3/8-24 drill spindle, replaces adjustable jaw chuck
801-6-9020	1/4" hex power bit shaft for screwgun installation

Quick Chucks

Quick Chucks are the heart of the Quick Change System. They can be locked into a regular drill chuck to convert it to a super fast (instant) Quick Change System - even faster and easier than keyless chucks.

Code #	Bore Size
801-6-2004	1/16"
801-6-2005	5/64"
801-6-2006	3/32"
801-6-2007	7/64"
801-6-2008	1/8"
801-6-2009	9/64"
801-6-2010	5/32"
801-6-2011	11/64"
801-6-2012	3/16"
801-6-2013	13/64"
801-6-2014	7/32"
801-6-2015	15/64"
801-6-2016	1/4"
801-6-2017*	1/4"
801-6-2020*	5/16"
801-6-2024*	3/8"

Drill Bit and Tool Adapters

Quick Change Adapters convert Cryotool drill bits or other drill bits or rotary tools into Quick Change 1/4" hex power bits. Twist drills and tools are securely held in the adapters by a set screw (two set screws in larger sizes), which is tightened in place with a 1/8" hex wrench.

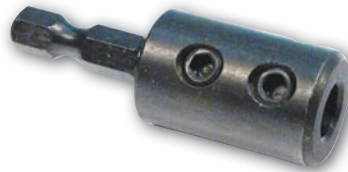

*Two set screws in each adapter - use for rotary tools and larger drill bits



Code #	Description
801-6-2000	15 Sizes of Cryobits 1/16" through 3/8" to fit hex shank adapters
801-6-2002	One each of every Quick Change Adapter (16 sizes total) with 1/8" hex key
058-0-1305	1/8" Hex Key

Storage Hardware	
750-8-0004	Wooden Storage Block holds all sizes of Quick Change Chucks plus hex key

